



Tel. (506) 2222-0908 • Fax (506) 2223-0908 • info@multi.cr
San José, Costa Rica





CONTENTS

- 
- 01 BEST DOOR
- 02 CERTIFICATIONS
- 03 STEEL FIRE DOOR
- 13 WOODEN FIRE DOOR
- 21 SECURITY ENTRANCE DOOR
- 41 SECURITY ARMORED DOOR
- 45 INTERIOR DOOR
- 55 ACCESSORIES



MANUFACTURER

Chongqing Mexin Best Doors Industry Co. Ltd. is one of the leading door manufacturers in China, which established in 2002. Through 15 years of development, Mexin Best has established a complete organizational structure, including technique research, manufacture, marketing and after service departments. Main products covers Fire rated doors, safety security doors, commercial doors, interior MDF doors, solid wooden doors, automatic garage doors and industry doors. Thanks for positive technique research and international market exploration, Mexin Best have successfully entered to over 30 countries, such as US, European countries, Middle east and South Asian countries, and gained good reputation. It helps Mexin Best keeping stable business relationship with customers of these countries and regions. At the same time, Mexin Best is also very popular in domestic market. The unique and personal design attracts more and more users to choose Mexin Best. Complete range of product line can meet different requirements of various kinds of customers.

Mexin Best contributes to public welfare undertaking, advocating a new generation of industrialization through individual design, scale production and international business concepts. Mexin Best invested to public facility and developed tourism industry to improve the work environment. Mexin Best believes simplicity is beauty, with absorbing advanced international administration experience and humanity care. Mexin Best will introduce more beautiful doors to our life.



CERTIFICATIONS

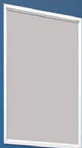

**STEEL
FIRE
DOOR**



STEEL FIRE DOOR

Fire Rating from
20Min up to 3Hrs



Chongqing Mexin Best Doors Industry Co., Ltd., The oldest steel fire door manufacturer in China that meets and exceeds ANSI/SDI standards, providing superior quality products, best services and competitive prices to our customers.



Industrial



Commercial



Educational



Hotel



Health



Institutional

STEEL FIRE DOOR

MAIN SPECS

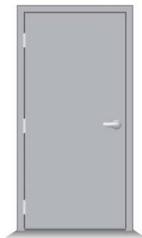

Mexin steel fire doors standard features include:

- 16, 18, 20 gauge flush and paneled doors
- Seamless door edge / edge seam optional
- Non-handed
- 3 hour WHIRLUL fire, positive pressure, and smoke label
- Cold rolled or A40 galvanized steel
- Prime painted with baked on water base paint
- 7 gauge hinge reinforcements
- 10 gauge closer reinforcement
- 16 gauge flush sealed top channel / inverted bottom channel
- Closed hinge cavity
- High density full body polystyrene or honeycomb core
- Blank edge door includes rim exit device reinforcements
- Individual protective packaging

STANDARD DOOR SPECS

Door Styles

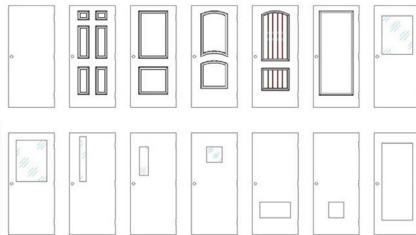

DOOR CONSTRUCTION DETAILS

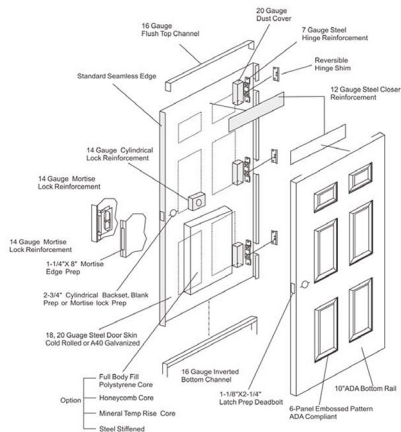

STANDARD DOOR FEATURES

Door construction

- ◆ Center seamless
- ◆ Lock seam edge
- ◆ Corner seam edge

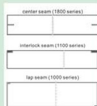

Door Cores

- ◆ Steel stiffener
- ◆ Polystyrene
- ◆ Honeycomb paper
- ◆ Temp rise mineral core
- ◆ Polyurethane (non-rated)

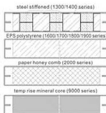

FRAME CONSTRUCTION DETAILS

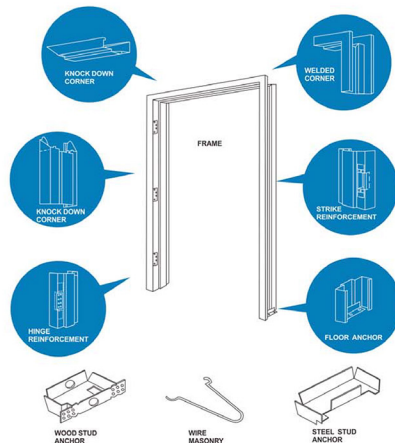

Frame Profiles



Maxin steel fire doors conform or exceed SDI/HMMA industrial standards, fire tested and certified with UL, Intertek/WH from 20Min up to 3hrs fire rating, complying criteria as NFPA252, UBC7-2, UL 10(b), UL 10(c)

TYPICAL FRAME TYPES

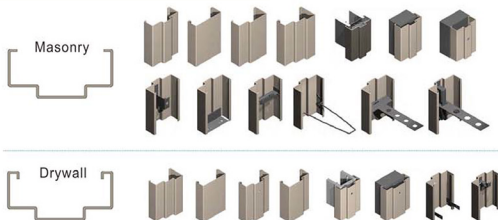

HANDING CHARTS

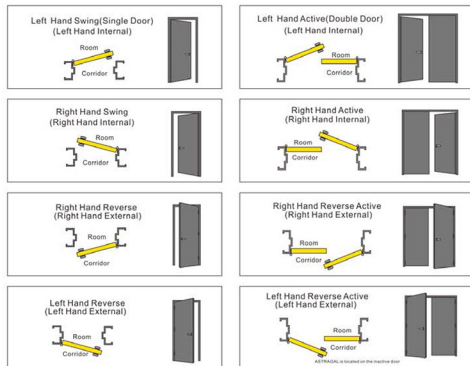

STEEL FIRE DOOR IN APPLICATIONS

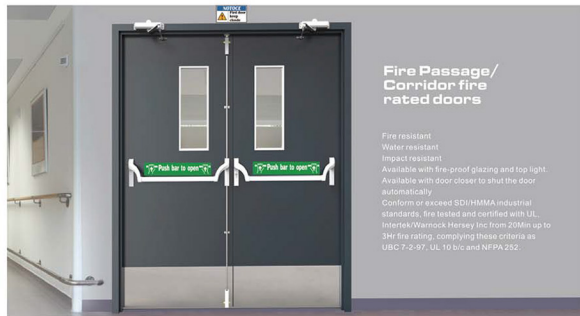

STEEL FIRE DOOR IN APPLICATIONS



BT2WB2050GP

EMERGENCY EXIT

Fire resistant
Water resistant
Impact resistant
Available with door closer to shut the door automatically
Passed all relevant tests and inspection of National Standard for fire-rated door sets, fire rated from 20 mins up to 3 hours.



BT2WB2000GP/00

INDUSTRY DOOR

Fire resistant
Water resistant
Impact resistant
Available with door closer to shut the door automatically
Conform or exceed SDI/HMMA industrial standards, fire tested and certified with UL, Intertek/Warnock Hersey Inc from 20Min up to 3Hr fire rating, complying these criteria as UBC 7-2-97, UL 10b/c and NFPA 252.

STEEL FIRE DOOR IN APPLICATIONS



OUT-PATIENT/ EMERGENCY DEPARTMENT

Water resistant
Impact resistant
Easy operation
Various options
Precise sealing structure and high quality sealing strip of the frame realize a perfect sound insulation
Plenty of optional color
Aluminum or steel louver to achieve perfect ventilation
Sturdy nylon lock latch allows door to operate quietly
Available with equal cylinder key system



FUNCTION ROOMS

Water resistant
Impact resistant
Perfect sound insulation
Fire resistant
Conform or exceed SDI/HMMA industrial standards, fire tested and certified with UL, Intertek/Warnock Hersey Inc from 20Min up to 3Hr fire rating, complying these criteria as UBC 7-2-97, UL 10 b/c and NFPA 252.



EQUIPMENT DOOR

Fire resistant
Impact resistant
Available with door closer to shut the door automatically
Water resistant
Aluminum or steel louver to achieve perfect ventilation





**WOODEN FIRE
DOOR**

WOODEN FIRE DOOR

FIRE DOOR 30MIN/60MIN



FD30/FD60 WOODEN FIRE DOOR
Specification in accordance

Mexin FD30/60 Tested door and frame to ASTM E152-81A; UL10C (1998); ASTM E2074(2000); NFPA 252 (2012) by Intertek.

DOOR

Overall 1-3/4" minimum (44mm) with solid core in a high density particle board Door set certified as resistant to fire for 30 minutes (Fd30). Suitable door set for apartments, offices and commercial building Facing in MDF or Veneer Hardboard according with finish Available in lipped specification. FSC® Certification applies to Standard options.

FRAME

Solid wood Jamb(FD60) and Metal Jamb(FD180) available
Adjustable architrave available

IRONMONGERY

Stainless steel UL marked hinges
Standard Latch or Lock
UL certified Panic Bar (Push Bar)
UL certified Door Closer
Digital Lock and S.S. plate available

OPTION

Automatic drop seal and Threshold available
Oversized Door and Frame
Pre-painted color as RAL color chart

FEATURE



Fire resistance is one of the most fundamental performance criteria for doorsets, resulting in a complexity of interrelated regulations, standards and guides.

A fire door is not just a "door leaf"; it is a complete door assembly encompassing ancillary products, such as, intumescent strips, smoke seals and fire-tested ironmongery. A full, certified fire door assembly will ensure that the fire door will react accordingly within a fire situation and delay the spread of fire within a building, ensuring that people have enough time to escape the building and find safety.

Mexin offers an array of Primer-painted MDF, laminated and veneered fire doors in a variety of styles, colors and wood grain finishes. Fire doors are available unfinished or fully-finished in 30-minute and 60-minute options. Our fire rated doors and doorsets are compliant with all relevant North America Standards and have been tested in accordance with UL 10C. Popular fire-rated hardware options are also available

STANDARD DETAILS

TECHNICAL SHEET

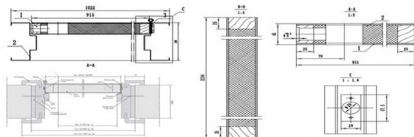

Our wooden fire doors in 30- through 60-minute fire ratings.

	30-minute Wood	60-minute Wood
Category	Category A Category B Neutral Pressure	Category A Category B
Thickness	1-3/4" minimum (44mm)	1-3/4" minimum (44mm)
Maximum width single	3'0"	3'0"
Maximum height	8'0"	8'0"
Fire glass max. area	3,145 sq. inches	1,248 sq. inches (20 minutes) 1,216 sq. inches (60 minutes)
Standards	ASTM E-152, NFPA 80, NFPA 252, UL10B, UL10C	

Glazing system require metal vision kit.

SPECIFICATION

Core Specification Details

Fireshield FD30 - A high density particle board, which requires no timber framing, at a thickness of 44mm. When correctly installed with suitable intumescent strips as a doorset assembly, the door will provide certified fire resistance.

Flush face (MDF) or Wood veneer face with softwood stiles and rails and complementing hardwood lipping.

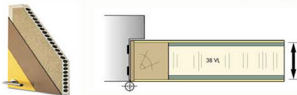

Fire Rating

FD30 1-3/4" minimum (44mm) 30min to ASTM E-152, NFPA 80, NFPA 252, UL 10B, UL 10C

FD60 1-3/4" minimum (44mm) 30min to ASTM E-152, NFPA 80, NFPA 252, UL 10B, UL 10C

Moisture Content

10% (+/-2%)

Color Chart

Primer Painted Color



Lamination



Veneer / Full finish Painting



SPECIFICATION

Finish

Door					
Door facing, finishes and performance	Particle Board Core	MDF	HDF & Melamine paper	MDF & PVC film Laminate	Veneer
Finish option					
Primed Painting	-				
Full Finish Painting					
Color	-	RAL Chart	Wooden Texture	Wooden Texture	Wooden Texture
Fire Performance	FD30	✓	✓	✓	✓
	FD60	✓	✓	✓	✓

Frame			
Frame materials, finishes and performance	Hardwood	Hardwood & Veneer	Steel / S.S.
Finish option	-	-	-
Primed Painting			
Full Finish Painting			
Color	RAL Chart	Wooden Texture	RAL Chart
Fire Performance	FD30		
	FD60	✓	✓

Timber Frames are available in hardwood that can be polished or painted.

Steel Steel frames are available powder-coated to any RAL colour or supplied in a stainless finish.

Metal facings Patterned and brushed stainless steel sheet
Metal finishes can be supplied and can be left clean, primed or powder-coated, with the exception of patterned stainless steel which is self-finished.



**SECURITY
ENTRANCE
DOOR**



SECURITY ENTRANCE DOOR

STRUCTURAL SPECIFICATION

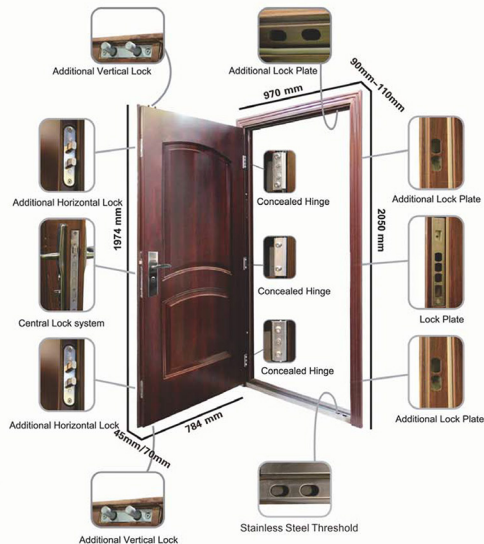
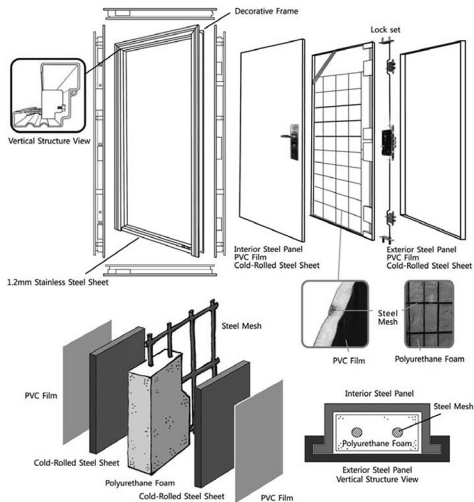

TECHNICAL SPECIFICATIONS

"MEXIN BEST" Doors specializes in the manufacturer of the highest quality steel security entrance doors based on years of product development, knowledge and expertise. A broad range of security Entrance doors are available suiting customer's different needs.

General Description

The door leaf made of two 0.7mm thick cold rolled steel sheets with vertical and horizontal steel reinforcements for optimal security structure.

The door leaf is filled with polyurethane foam with steel mesh

Door leaf thickness:

- ◆ 45mm
- Frame made of 2.0mm thick cold rolled steel sheets

Option:

- ◆ 0.6mm/0.8mm/1.0mm cold rolled steel or galvanized steel for door leaf
- ◆ 1.5mm/1.8mm/2.0mm cold rolled steel or galvanized steel for frame
- ◆ Infilling material can be honeycomb for thermal

DOOR FINISH:

- ◆ PVC film coating
- ◆ Powder coated
- ◆ Heat transferring

DIMENSIONS:

standard size of 2050x970mm 2050x870mm



MODELS

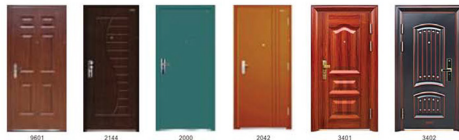

TECHNICAL SPECIFICATIONS

Door leaf

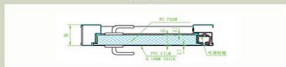

Locking System

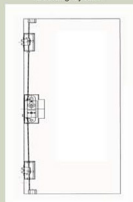

Frame

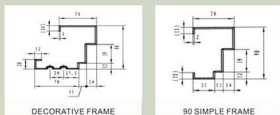

DECORATIVE FRAME

90 SIMPLE FRAME

STEEL SECURITY DOOR INTRODUCTION

Model No.: 2141

Standard size: 2050*970mm 2050*870mm

Doorleaf thickness: 45mm 70mm

Door frame thickness: 90mm-110mm

Filling material: polyurethane foam with reinforcement steel mesh or honeycomb paper

Doorleaf material: 0.6mm/1.0mm cold rolled steel sheet

Door frame material: 1.5/1.8/2.0mm cold rolled steel sheet

Surface finish: PVC film coating

STEEL SECURITY DOOR



STEEL SECURITY DOOR INTRODUCTION

Model no.: 2172

Standard size: 2050*1170mm 2050*1270mm

Doorleaf thickness: 45mm 70mm

Door frame thickness: 90mm-110mm

Filling material: polyurethane foam with reinforcement steel mesh or honeycomb paper

Doorleaf material: 0.8mm/1.0mm cold rolled steel sheet

Door frame material: 1.5/1.8/2.0mm cold rolled steel sheet

Surface finish: PVC film coating

STEEL SECURITY DOOR



STEEL SECURITY DOOR INTRODUCTION

Model no.: 2173

Standard size: 2050*1170mm 2050*1270mm

Doorleaf thickness: 45mm 70mm

Door frame thickness: 90mm-110mm

Filling material: polyurethane foam with reinforcement steel mesh or honeycomb paper

Doorleaf material: 0.8mm/1.0mm cold rolled steel sheet

Door frame material: 1.5/1.8/2.0mm cold rolled steel sheet

Surface finish: PVC film coating

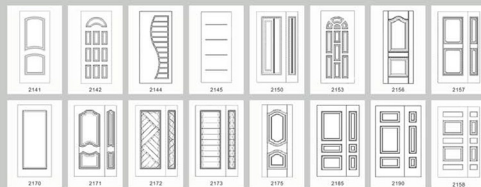

STEEL GLASS ENTRANCE DOOR

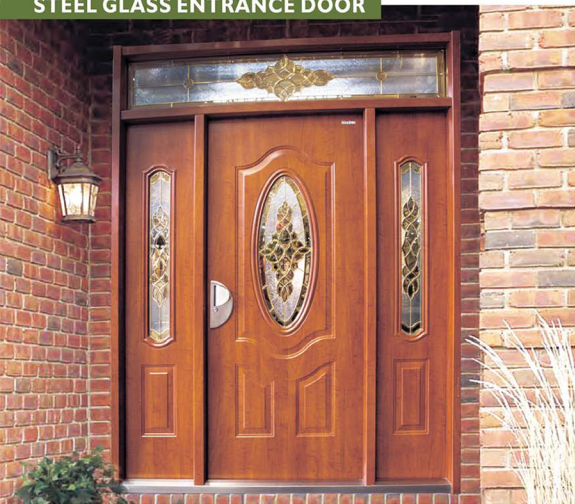

STEEL GLASS SECURITY DOOR INTRODUCTION

Model No.: 2004 2019 9709 9603 N967 2051 2091

Standard size: 2050*970mm 2050*1170mm

Doorleaf thickness: 45mm

Door frame thickness: 90mm-110mm

Filling material: Polyurethane foam or honeycomb paper

Doorleaf material: 0.8mm/1.0mm cold rolled steel sheet

Door frame material: 1.5/1.8/2.0mm cold rolled steel sheet

Surface finish: PVC film coating

STEEL GLASS ENTRANCE DOOR

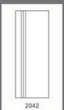
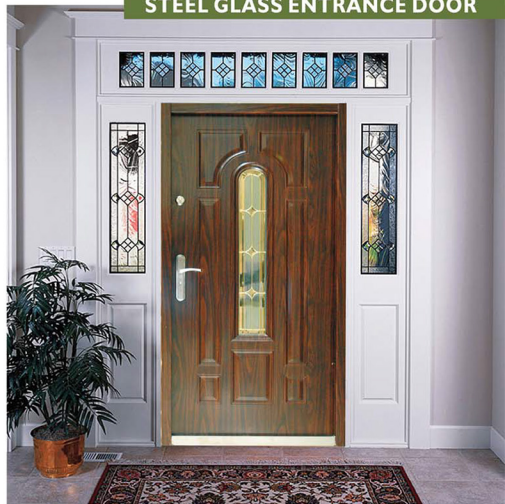

TECHNICAL SPECIFICATIONS

"MEXIN BEST" Doors specializes in the manufacturer of the highest quality steel security entrance doors based on years of product development, knowledge and expertise. A broad range of security Entrance doors are available suiting customer's different needs.

General Description

The door leaf made of two 0.8mm thick cold rolled steel sheets with vertical and horizontal steel reinforcements for optimal security structure. The door leaf is filled with polyurethane foam with wooden rails

Door Leaf Thickness:

◆ 55mm

Option:

- ◆ 0.8mm/0.8mm/1.0mm cold rolled steel or galvanized steel for door leaf
- ◆ 1.5mm/1.8mm cold rolled steel or galvanized steel for frame
- ◆ Infilling material can be honeycomb or polystyrene for thermal

Door Finish:

- ◆ PVC film coating
- ◆ Powder coated.
- ◆ Painting

DIMENSIONS:

standard size of 2089x1008mm 2050x970mm



MODELS



STEEL DOOR MODEL LIST

TECHNICAL SPECIFICATIONS

Lock System



Door leaf

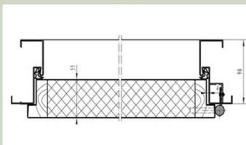

Frame

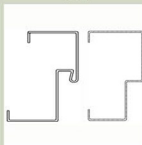

STEEL SECURITY DOOR



STEEL SECURITY DOOR DOOR INTRODUCTION

Model No.: BT1ABB011GG
Standard size: 2100*1000mm
Door leaf thickness: 45mm
Door frame thickness: 120mm
Filling material: honeycomb paper
Door leaf material: 0.8mm/1.0mm cold rolled steel sheet
Door frame material: 1.4/1.8/2.0mm cold rolled steel sheet
Surface finish: Powder coating

STEEL SECURITY DOOR



STEEL SECURITY DOOR DOOR INTRODUCTION

Model No.: BT1ABB012GG
Standard size: 2100*1000mm
Door leaf thickness: 45mm
Door frame thickness: 120mm
Filling material: honeycomb paper
Door leaf material: 0.8mm/1.0mm cold rolled steel sheet
Door frame material: 1.4/1.8/2.0mm cold rolled steel sheet
Surface finish: Powder coating

STEEL SECURITY DOOR DOOR INTRODUCTION

Model No.: BT1ABB013GG
Standard size: 2100*1000mm
Door leaf thickness: 45mm
Door frame thickness: 120mm
Filling material: honeycomb paper
Door leaf material: 0.8mm/1.0mm cold rolled steel sheet
Door frame material: 1.4/1.8/2.0mm cold rolled steel sheet
Surface finish: Powder coating



STEEL SECURITY DOOR DOOR INTRODUCTION

Model No.: BT1ABB010GG
Standard size: 2100*1000mm
Door leaf thickness: 45mm
Door frame thickness: 120mm
Filling material: honeycomb paper
Door leaf material: 0.8mm/1.0mm cold rolled steel sheet
Door frame material: 1.4/1.8/2.0mm cold rolled steel sheet
Surface finish: Powder coating



STEEL SECURITY DOOR



STEEL SECURITY DOOR DOOR INTRODUCTION

Model No.: WZ20D7554FFMB
Standard size: 2050*970mm 2050*1170mm
Door leaf thickness: 75mm
Door frame thickness: 100mm
Filling material: honeycomb paper
Door leaf material: 0.8mm/1.0mm cold rolled steel sheet
Door frame material: 1.4/1.8/2.0mm cold rolled steel sheet
Surface finish: PVC film coating

STEEL SECURITY DOOR



STEEL SECURITY DOOR DOOR INTRODUCTION

Model No.: WZ10D7511FFMB
Standard size: 2050*970mm 2050*1170mm
Door leaf thickness: 75mm
Door frame thickness: 100mm
Filling material: honeycomb paper
Door leaf material: 0.8mm/1.0mm cold rolled steel sheet
Door frame material: 1.4/1.8/2.0mm cold rolled steel sheet
Surface finish: PVC film coating

STEEL SECURITY DOOR DOOR INTRODUCTION

Model No.: WZ10D7521FFMB
Standard size: 2050*970mm 2050*1170mm
Door leaf thickness: 75mm
Door frame thickness: 100mm
Filling material: honeycomb paper
Door leaf material: 0.8mm/1.0mm cold rolled steel sheet
Door frame material: 1.4/1.8/2.0mm cold rolled steel sheet
Surface finish: PVC film coating



STEEL SECURITY DOOR DOOR INTRODUCTION

Model No.: WZ20D1003DRRB
Standard size: 2050*970mm 2050*1170mm
Door leaf thickness: 75mm
Door frame thickness: 100mm
Filling material: honeycomb paper
Door leaf material: 0.8mm/1.0mm cold rolled steel sheet
Door frame material: 1.4/1.8/2.0mm cold rolled steel sheet
Surface finish: PVC film coating





**SECURITY
ARMORED DOOR**

 **AVANTI**[®]
LE PORTE



INTRODUCTION

MEXIN BEST® Doors specializes in the manufacturer of the highest quality security armored doors based on years of product development, knowledge and expertise. A broad range of security Armored doors are available suiting customer's different needs.

TECHNICAL SPECIFICATIONS



BT1WL5022CF

General Description

The door leaf made of two 1mm thick galvanized steel sheets with vertical and horizontal steel reinforcements for optimal security structure. The door leaf is filled with polystyrene foam or Rockwool and honeycomb for thermal and acoustic insulation. Various designs and finishes.

Locking System

Different multiple point locking point lock. Improved cylinder protector preventing picking and drilling as well as forcing of the lock cylinder.

Frame

Construction frame made of 1.5mm thick galvanized steel. The frame is mounted directly on the wall with expansion screw to the building structure.

DOOR FINISH

Painting.
Powder coating.

DIMENSIONS

Door Width: 600-1100 mm.
Door Max Height: 2400 mm.

MODEL SHOWS



BT1VL5001CF



BT1VL5002CF



BT1VL5003CF



BT1VL5004CF



BT1VL5005CF



BT1VL5006CF



BT1VL5007CF



BT1VL5008CF



BT1VL5009CF



SECURITY ARMORED DOOR

MODEL SHOWS



BT1VL5010CF



BT1VL5011CF



BT1VL5012CF



BT1VL5013CF



BT1VL5014CF



BT1VL5015CF



BT1VL5016CF



BT1VL5017CF



BT1WL5023CF

The door leaf made of two 1mm thick galvanized steel sheets with vertical and horizontal steel reinforcements for optimal security structure. The door leaf is filled with polystyrene foam or Rockwool and honeycomb for thermal and acoustic insulation. Various designs and finishes.

SECURITY ARMORED DOOR

MODEL SHOWS



BT1VL5018CF



BT1VL5019CF



BT1VL5020CF



BT1VL5021CF



TECHNICAL DRAWINGS

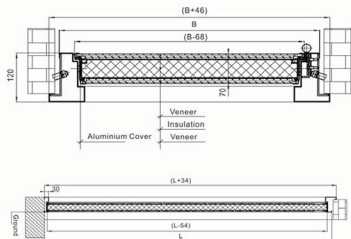



**INTERIOR
DOOR**

AVANTI
LE PORTE

FEATURES INSTRUCTION

Mexin flush door offer thousands of design options to suit any requirement. Start by choosing a distinctive design from our portfolio on the following pages, then enhance your selection with a combination of sticking, panel and moulding profiles.

1. Made from a solid piece of double-refined MDF
2. One-piece construction assures superior appearance and stability for years to come.
3. Seamless-no stile & rail joints visible
4. Glass and other insert options available
5. Precision-crafted, mitered panels and crisp lines are the result of a computer-controlled manufacturing and painstaking hand craftsmanship

MDF BOARD

Medium-density fiberboard is a wood product engineered from hard or soft wood fibers combined with water-resistant binding materials, then subjected to extreme temperature and pressure to form durable, solid panels. MDF construction results in a material much stronger and denser than particle board, yet with a smoother, more consistent appearance than traditional wood.

FLUSH DOOR EDGE

Mexin flush door edge adopts a superior edge finish, provides the highest durability and performance in the industry. We use only double refined MDF in our doors and we prime all surfaces and edges to ensure a long-lasting finish. Whatever your needs, requirements and specifications, we have a solution for you to make your next project a resounding success by cost effective solutions.

HONEYCOMB PAPER

Honeycomb paper is made of high strength corrugated paper which processed through glue spreading, stacking, ressing, cutting, then stretchen to regular hexagon. It is a new resources saving material which has following features:

- a. Light specific weight, high compressive strength, toughness and stable mechanical property
- b. Sound & thermal insulation, humidity proof and nontoxicity.
- c. Anti-vibration and excellent buffering.
- d. Flame retardancy and flat & straight appearance
- e. Environmental protection and resources saving



STRUCTURAL SPECIFICATION

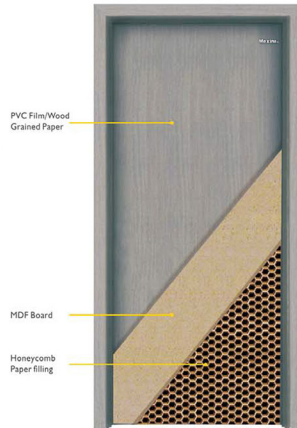
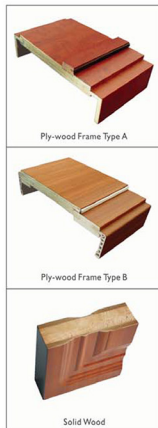

Section

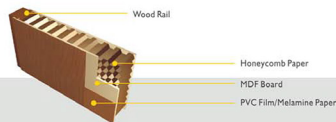

FLUSH DOOR



Model NO.: 2042

Doorleaf height: 2100mm\2050mm\2000mm\1950mm\1900mm

Doorleaf width: 850mm\800mm\750mm\700mm\650mm

Doorleaf thickness: 40mm

Doorleaf MDF board thickness: 3mm

Filling material: Honeycomb paper/Solid wood

Surface finish: Wood grained paper with painting

Frame material: 28mm plywood

FLUSH DOOR

Model NO.: 2040

Doorleaf height: 2100mm\2050mm\2000mm\1950mm\1900mm

Doorleaf width: 850mm\800mm\750mm\700mm\650mm

Doorleaf thickness: 40mm

Doorleaf MDF board thickness: 3mm

Filling material: Honeycomb paper/Solid wood

Surface finish: Wood grained paper with painting

Frame material: 28mm plywood



FLUSH DOOR



Model NO. : 7093
Doorleaf height: 2100mm\2050mm\2000mm\1950mm\1900mm
Doorleaf width: 850mm\800mm\750mm\700mm\650mm
Doorleaf thickness: 40mm
Doorleaf MDF board thickness: 3mm
Filling material: Honeycomb paper/Solid wood
Surface finish: Wood grained paper with painting
Frame material: 28mm plywood

FLUSH DOOR

Model NO. : N879
Doorleaf height: 2100mm\2050mm\2000mm\1950mm\1900mm
Doorleaf width: 850mm\800mm\750mm\700mm\650mm
Doorleaf thickness: 40mm
Doorleaf MDF board thickness: 3mm
Filling material: Honeycomb paper/Solid wood
Surface finish: Wood grained paper with painting
Frame material: 28mm plywood



FLUSH DOOR



Model NO.: 3311

Doorleaf height: 2100mm\2050mm\2000mm\1950mm\1900mm

Doorleaf width: 850mm\800mm\750mm\700mm\650mm

Doorleaf thickness: 40mm

Doorleaf MDF board thickness: 3mm

Filling material: Honeycomb paper/Solid wood

Surface finish: Wood grained paper with painting

Frame material: 28mm plywood

FLUSH DOOR



Model NO.: 2032
Doorleaf height: 2100mm\2050mm\2000mm\1950mm\1900mm
Doorleaf width: 850mm\800mm\750mm\700mm\650mm
Doorleaf thickness: 40mm
Doorleaf MDF board thickness: 3mm
Filling material: Honeycomb paper/Solid wood
Surface finish: Wood grained paper with painting
Frame material: 28mm plywood



ACCESSORIES

**MULTI**

ACCESSORIES

PANIC EXIT DEVICE



PET-01



PET-02



PET-03



PET-04



PET-05



PET-06



MORTISE LOCK

CML800 SERIES

ANSI Commercial Mortise Locks

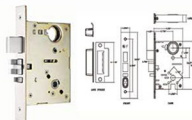

Universal lock case-many functions in one case
 Field-reversible handing without opening lock case
 Locking thumbturn on the inside of door visually shows when the door is locked and unlocked
 Independent lever rotation

72-60A, FIRE RATED LOCK

Dead bolt and latch is made by stainless steel 304
 Forend is made by stainless steel 304
 Follower is casting stainless steel 304
 None Handed
 Finish: satin, polished, PVD, AB

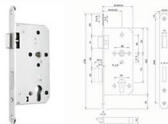

4500 SERIES

Meets ADA requirements.
 Specially designed for
 Barrier Free Application
 Conforms with ANSI A156.2
 Series 4500, Grade 2
 Exceeds 400,000 cycles.



CYLINDER

key/Turn Cylinder



Dimension(mm)

A	B	C
65	32.5	32.5
70	35	35
75	37.5	37.5
80	40	40

Half Cylinder



Dimension(mm)

A	B	C
40	35	5
45	40	5

key/key Cylinder

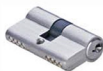

Dimension(mm)

A	B	C
65	32.5	32.5
70	35	35
75	37.5	37.5
80	40	40

Turn Models



D01



D02



D03

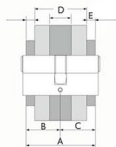

$$A = D + E \times 2$$

D-Thickness of door
E-Height of escutcheon

E usually this is one escutcheon
on each side of the door

Always check the mortise lock
is fitted in the middle of the door,
if not, an offset cylinder is required.

Master Key
Over Key and Construction Key
6 Levers is available

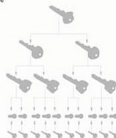

EN TUBE LEVER HANDLE



HD-01



HD-02



HD-03



HD-04



HD-05



HD-06



HD-07



HD-08



HD-09



HD-10



HD-11



HD-12



HG-01



HG-02



HG-03



HG-04

FIRE RATED DOOR CLOSER

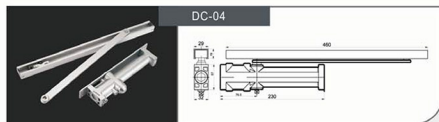
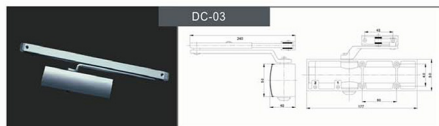
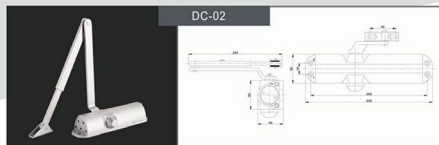
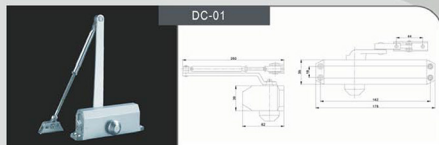

PULL HANDLE

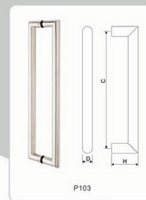
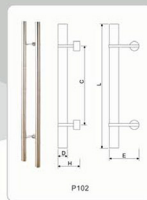

OTHER

